



KONICA MINOLTA

bizhub C3100P

✍ Colour A4 printer

✍ Up to 31 pages per minute

✍ Functionality



Printing

- Colour
- Black & white
- PCL/PS
- Local/Network
- USB



Giving Shape to Ideas

Technology

Emperon™ – print controller	Easily compatible with different users and IT environments through Konica Minolta's unified print technology	✓
Simitri® HD – polymerised toner	Delivers high print quality and yet ensures reduced print spending as well as lower environmental impact	✓
OpenAPI – solution platform	Server-based applications provide efficient workflows for the entire MFP fleet	✗
i-Option – special feature	Offers extended scope and advanced MFP functionality in line with individual requirements	✓
CSRC – remote service	Keeps productivity up with online monitoring of devices and consumables through the Konica Minolta service	✓
IWS – panel customisation	Improved user-device interaction and enhanced productivity through full MFP panel customisation	✗

Option diagram

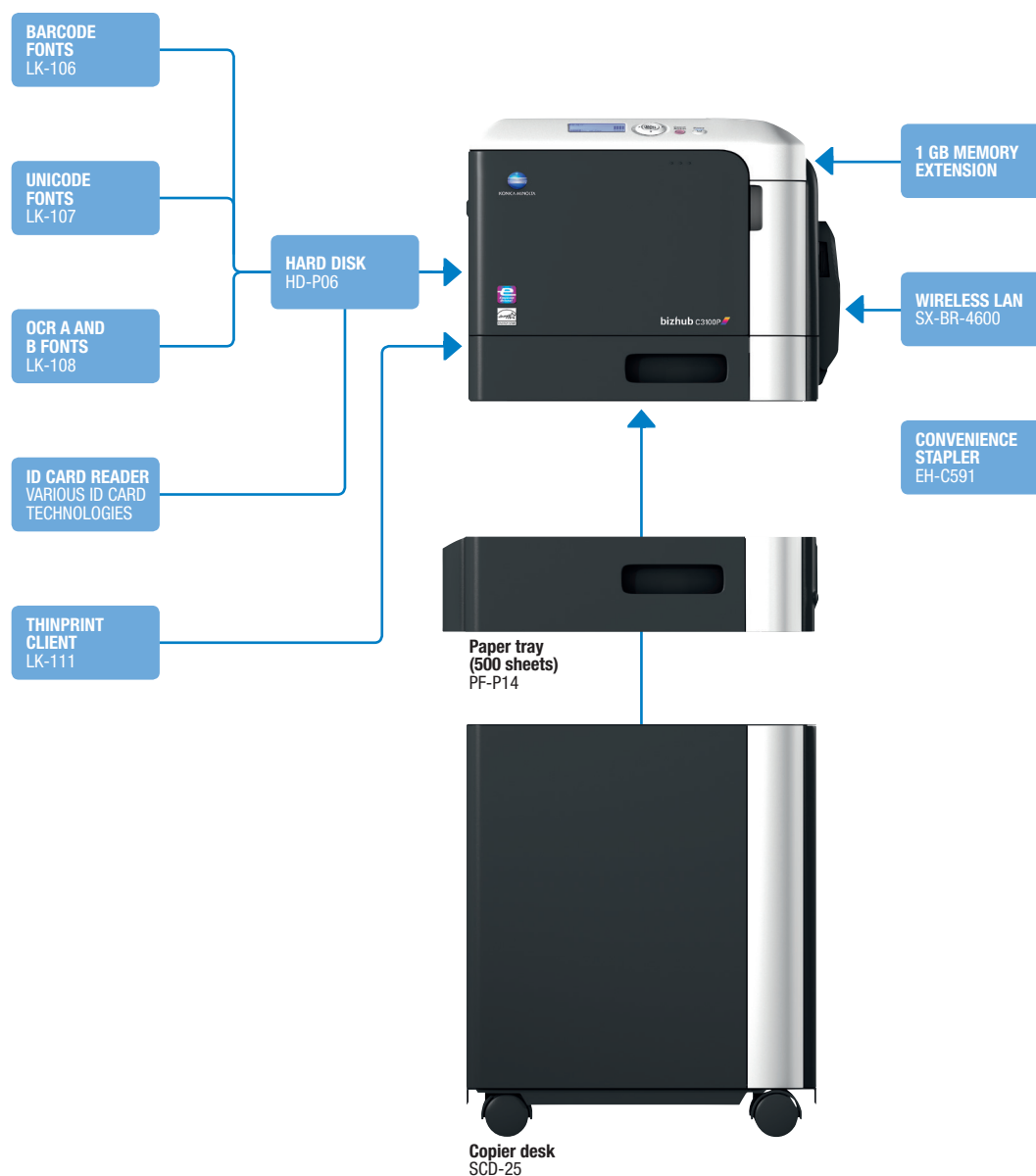

Finishing functionality



Duplex

Descriptions

bizhub C3100P	A4 Printer with 31 ppm b/w and colour. Standard Emperon™ print controller with PCL, PostScript and optional XPS support. Paper capacity of 250 sheets and 100-sheet manual bypass. Duplex unit standard. 1 GB memory and Gigabit Ethernet standard.
PF-14 Paper tray	A4; 500 sheets; up to 90 gsm
SCD-25 Copier desk	Ensures economic height and provides storage space for print media, etc.

HD-P06 Hard disk¹	320 GB hard disk
1 GB Expanded memory	1 GB memory extension for faster processing
ID card reader¹	Various ID card technologies
LK-106 Barcode fonts¹	Supports native barcode printing
LK-107 Unicode fonts¹	Supports native Unicode printing
LK-108 OCR A and B fonts¹	Supports native OCR A and B font printing
LK-111 ThinPrint® Client	Print data compression for reduced network impact
SX-BR-4600 Wireless LAN	Wireless LAN to network connector
EH-C591 Convenience stapler	Convenient stapling of up to 50 prints per set

Technical specifications

SYSTEM SPECIFICATIONS

System memory	1 GB (standard) 2 GB (optional)
System hard disk	320 GB (optional)
Interface	10-Base-T/100-Base-TX/1,000-Base-T Ethernet; USB 2.0
Network protocols	TCP/IP (IPv4 / IPv6); SMB; LPD; IPP; SNMP; HTTP; HTTPS
Frame types	Ethernet 802.2; Ethernet 802.3; Ethernet II; Ethernet SNAP
Printable paper size	A6–A4; customised paper sizes
Printable paper weight	60–210 gsm
Paper input capacity	Standard: 350 sheets Max.: 850 sheets
Tray 1	250 sheets; A6–A4; 60–210 gsm
Tray 2 (optional)	500 sheets; A4; 60–90 gsm
Manual bypass	100 sheets; A6–A4; custom sizes; 60–210 gsm
Automatic duplexing	A4; 60–210 gsm
Output capacity	Max.: 200 sheets
Copy/print volume (monthly)	Rec.: 6,500 pages Max. ² : 120,000 pages
Toner lifetime	CMYK: 5,000 pages
Imaging unit lifetime	Black: 25,000 pages; CMY: 25,000 pages
Power consumption	220–240 V / 50/60 Hz Less than 1.2 kW (system)
System dimensions (W x D x H)	447 x 544 x 350 mm
System weight	Approx. 24 kg

PRINTER SPECIFICATIONS

Copying process	Electrostatic laser copy, tandem, indirect
Toner system	Simitri® HD polymerised toner
Print speed A4 (mono/colour)	Up to 31 ppm
Autoduplex speed A4 (mono/colour)	Up to 31 ppm
1st copy out time (mono/colour)	12.9 sec.
Warm-up time	Approx. 36 sec. ³
Print resolution	1,200 x 1,200 dpi
Page description	PCL5e/c, PostScript 3 (CPSI 3016), XPS ¹
Operating systems	Windows VISTA (32/64) Windows 7 (32/64) Windows 8 (32/64) Windows Server 2003 (32/64) Windows Server 2008 (32/64) Windows Server 2008 R2 Windows Server 2012 (64) Windows Server 2012 R2 Macintosh OS X 10.x Linux Citrix
Printer fonts	80 PCL Latin, 137 PostScript 3 Emulation Latin
Print functions	Direct print ¹ of PDF; JPEG; TIFF; XPS ¹ and OOXML (DOCX; XLSX; PPTX); overlay; watermark; n-up

SYSTEM FEATURES

Security	IP filtering and port blocking; SSL2 ¹ ; SSL3 ¹ and TLS1.0 network communication ¹ ; IPsec support ¹ ; IEEE 802.1x support ¹ ; user authentication ¹ ; secure print ¹ ; hard disk overwrite (8 standard types) ¹ ; hard disk data encryption ¹
Software	PageScope Net Care Device Manager PageScope WebConnection PageScope Data Administrator PageScope Direct Print

¹ HD-P06 optional hard disk enables secure printing, proof-then-print, print & hold, job storing, XPS emulation, i-Option support and ID card reader support

² If the maximum volume is reached within a period of one year, then a maintenance cycle must be performed

³ Warm-up time may vary depending on the operating environment and usage

- All specifications refer to A4-size paper of 80 gsm quality.
- The support and availability of the listed specifications and functionalities varies depending on operating systems, applications and network protocols as well as network and system configurations.
- The stated life expectancy of each consumable is based on specific operating conditions such as page coverage for a particular page size (5% coverage of A4). The actual life of each consumable will vary depending on use and other printing variables including page coverage, page size, media type, continuous or intermittent printing, ambient temperature and humidity.
- Some of the product illustrations contain optional accessories.
- Specifications and accessories are based on the information available at the time of printing and are subject to change without notice.
- Konica Minolta does not warrant that any specifications mentioned will be error-free.
- All brand and product names may be registered trademarks or trademarks of their respective holders and are hereby acknowledged.



Simitri HD
High Definition Polymerised Toner

Simitri
with Biomass



SAP® Printer Vendor Solution

