



KONICA MINOLTA

bizhub C3110

✓ Colour A4 multifunctional

✓ Up to 31 pages per minute

Functionality



Copying

- Colour
- Black & white



Printing

- Colour
- Black & white
- PCL/PS
- Local/Network
- USB



Scanning

- Colour
- Black & white
- Scan-to-eMail
- Scan-to-SMB
- Scan-to-FTP

- Scan-to-HDD
- Scan-to-USB
- Scan-to-DPWS
- TWAIN Network



Faxing

- Super G3 Fax
- PC-Fax



Giving Shape to Ideas

Technology

Emperon™ – print controller	Easily compatible with different users and IT environments through Konica Minolta's unified print technology	✓
Simitri® HD – polymerised toner	Delivers high print quality and yet ensures reduced print spending as well as lower environmental impact	✓
OpenAPI – solution platform	Server-based applications provide efficient workflows for the entire MFP fleet	✗
i-Option – special feature	Offers extended scope and advanced MFP functionality in line with individual requirements	✓
CSRC – remote service	Keeps productivity up with online monitoring of devices and consumables through the Konica Minolta service	✓
IWS – panel customisation	Improved user-device interaction and enhanced productivity through full MFP panel customisation	✗

Option diagram

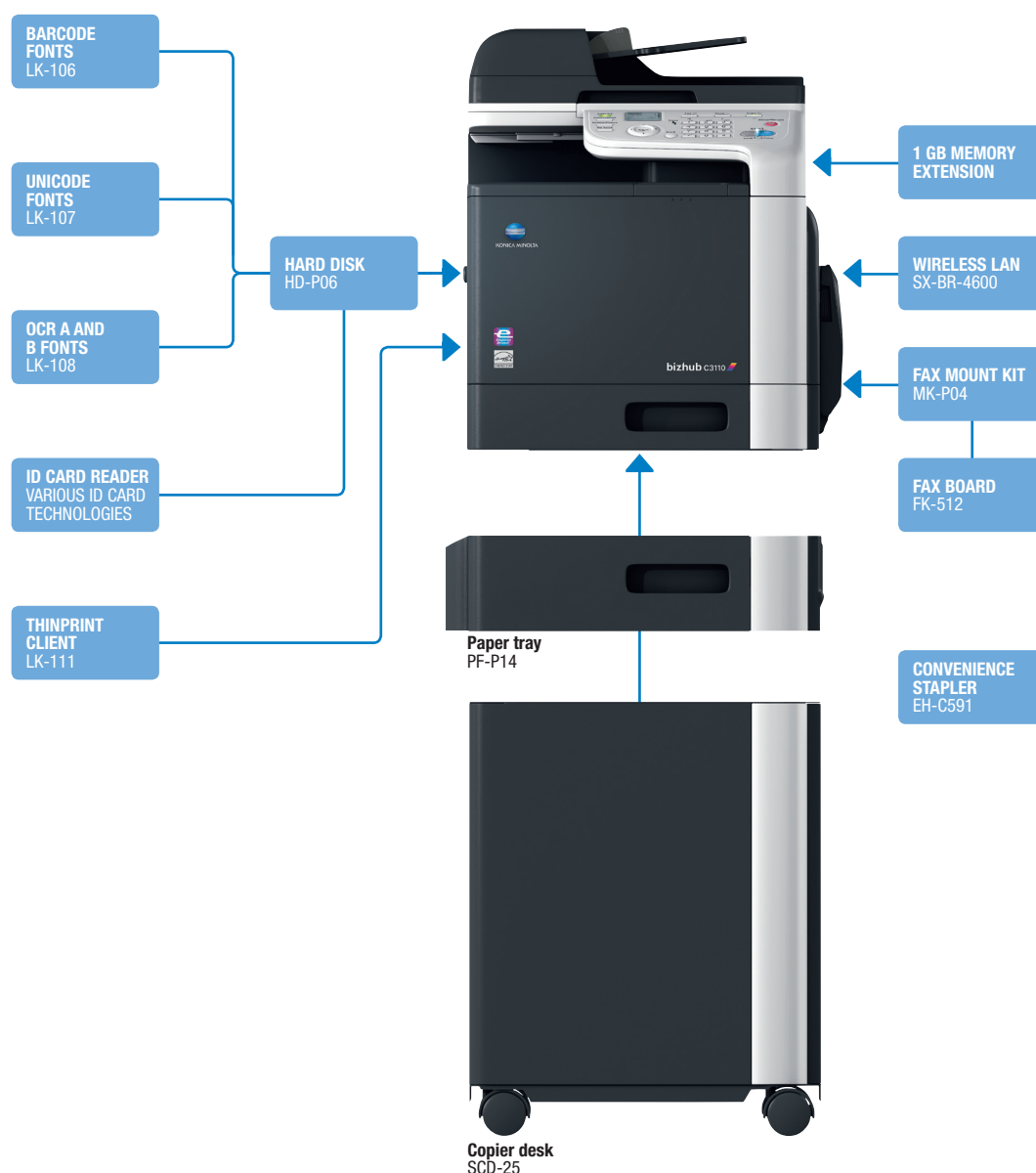

Finishing functionality



Duplex

Descriptions

bizhub C3110	A4 multifunctional with 31 ppm b/w and colour. Standard Emperon™ print controller with PCL, PostScript and optional XPS support. Paper capacity of 250 sheets and 100-sheet manual bypass. Automatic duplex document feeder and duplex unit standard. 1 GB memory and Gigabit Ethernet standard.
PF-P14 Paper tray	A4; 500 sheets; up to 90 gsm
SCD-25 Copier desk	Ensures economic height and provides storage space for print media, etc.
HD-P06 Hard disk	320 GB hard disk ¹

1 GB Expanded memory	1 GB memory extension for faster processing
FK-512 Fax board	Super G3 fax, digital fax functionality
MK-P04 Fax mount kit	Installation kit for fax board
ID card reader	Various ID card technologies ¹
LK-106 Barcode fonts	Supports native barcode printing ¹
LK-107 Unicode fonts	Supports native Unicode printing ¹
LK-108 OCR A and B fonts	Supports native OCR A and B font printing ¹
LK-111 ThinPrint® Client	Print data compression for reduced network impact
SX-BR-4600 Wireless LAN	Wireless LAN to network connector
EH-C591 Convenience stapler	Convenient stapling of up to 50 prints per set

Technical specifications

SYSTEM SPECIFICATIONS

System memory	1 GB (standard) 2 GB (optional)
System hard disk	320 GB (optional)
Interface	10-Base-T/100-Base-TX/1,000-Base-T Ethernet; USB 2.0
Network protocols	TCP/IP (IPv4 / IPv6); SMB; LPD; IPP; SNMP; HTTP; HTTPS
Frame types	Ethernet 802.2; Ethernet 802.3; Ethernet II; Ethernet SNAP
Automatic document feeder	Up to 50 originals; A6–A4; 50–110 gsm
Printable paper size	RADF
Printable paper weight	A6–A4; customised paper sizes
Paper input capacity	60–210 gsm
Tray 1	Standard: 350 sheets Max.: 850 sheets
Tray 2 (optional)	250 sheets; A6–A4; 60–210 gsm
Manual bypass	500 sheets; A4; 60–90 gsm
Automatic duplexing	100 sheets; A6–A4; custom sizes 60–210 gsm
Output capacity	A4; 60–210 gsm
Copy/print volume (monthly)	Max.: 150 sheets
Toner lifetime	Rec.: 6,500 pages Max. ² : 120,000 pages
Imaging unit lifetime	Black 5,000 pages; CMY 5,000 pages
Power consumption	Black 25,000 pages; CMY 25,000 pages
System dimensions (W x D x H)	220–240 V / 50/60 Hz Less than 1.2 kW (system)
System weight	447 x 544 x 500 mm
	Approx. 30 kg

COPIER SPECIFICATIONS

Copying process	Electrostatic laser copy, tandem, indirect
Toner system	Simitri® HD polymerised toner
Copy/print speed A4 (mono/colour)	Up to 31 ppm
Autoduplex speed A4 (mono/colour)	Up to 31 ppm
1st print out time (mono/colour)	13 sec.
Warm-up time	17 sec.
Copy resolution	Approx. 38 sec. ³
Gradation	600 x 600 dpi
Multi-copy	256 gradations
Original format	1–99
Magnification	A6–A4
Copy functions	25–400 % in 1 % steps; auto-zooming
	Duplex copy; ID card copy; 2-in-1; 4-in-1; poster; density adjustments

PRINTER SPECIFICATIONS

Print resolution	1,200 x 1,200 dpi
Page description language	PCL 5e/c PostScript 3 PDF 1.7 XPS ¹
Operating systems	Windows VISTA (32/64) Windows 7 (32/64) Windows 8 (32/64) Windows Server 2003/2008 (32/64) Windows Server 2012 (64) Macintosh OS X 10.x Linux Citrix
Printer fonts	80 PCL Latin 137 PostScript 3 Latin
Print functions	Direct print ¹ of TIFF, XPS ¹ , PDF and JPEG; XPS ¹ and OOXML (DOCX, XLSX, PPTX); secure print ¹ ; combination; n-up; poster; overlay; watermark

SCANNER SPECIFICATIONS

Scan speed (mono/colour)	Up to 30 ipm
Scan resolution	Max.: 600 x 600 dpi
Scan modes	Scan-to-eMail (Scan-to-Me) Scan-to-SMB (Scan-to-Home) Scan-to-FTP Scan-to-USB Scan-to-HDD ¹ Scan-to-DPWS Network TWAIN scan
File formats	TIFF; PDF; Compact PDF; JPEG; XPS ¹
Scan destinations	250 (shared with fax); LDAP support

FAX SPECIFICATIONS

Fax standard	Super G3 (optional)
Fax transmission	Analogue PC-Fax
Fax resolution	Max.: 600 x 600 dpi (ultra-fine)
Fax compression	MH; MR; MMR; JBIG
Fax modem	Up to 33.6 Kbps
Fax destinations	250 (shared with scan); LDAP support
Fax functions	Polling; time shift; PC-Fax

SYSTEM FEATURES

Security	ISO 15408 EAL3 (in evaluation) ¹ ; IP filtering and port blocking; SSL2 ² ; SSL3 ¹ and TLS1.0 network communication ¹ ; IPsec support ¹ ; IEEE 802.1x support ¹ ; user authentication ¹ ; secure print ¹ ; hard disk overwrite (8 standard types) ¹ ; hard disk data encryption ¹
Software	PageScope Net Care Device Manager PageScope WebConnection PageScope Data Administrator PageScope Direct Print

¹ 1 HD-P06 optional hard disk enables secure printing, proof-then-print, print & hold, job storing, XPS emulation, i-Option support and ID card reader support

² If the maximum volume is reached within a period of one year, then a maintenance cycle must be performed.

³ Warm up time may vary depending on the operating environment and usage

- All specifications refer to A4-size paper of 80 gsm quality.
- The support and availability of the listed specifications and functionalities varies depending on operating systems, applications and network protocols as well as network and system configurations.
- The stated life expectancy of each consumable is based on specific operating conditions such as page coverage for a particular page size (5% coverage of A4).
The actual life of each consumable will vary depending on use and other printing variables including page coverage, page size, media type, continuous or intermittent printing, ambient temperature and humidity.
- Some of the product illustrations contain optional accessories.
- Specifications and accessories are based on the information available at the time of printing and are subject to change without notice.
- Konica Minolta does not warrant that any specifications mentioned will be error-free.
- All brand and product names may be registered trademarks or trademarks of their respective holders and are hereby acknowledged.



Simitri HD
High Definition Polymerised Toner

Simitri
with Biomass



Visit our product page



SAP® Printer Vendor Solution

